

RevNo	Revision note	Date	Signature	Checked

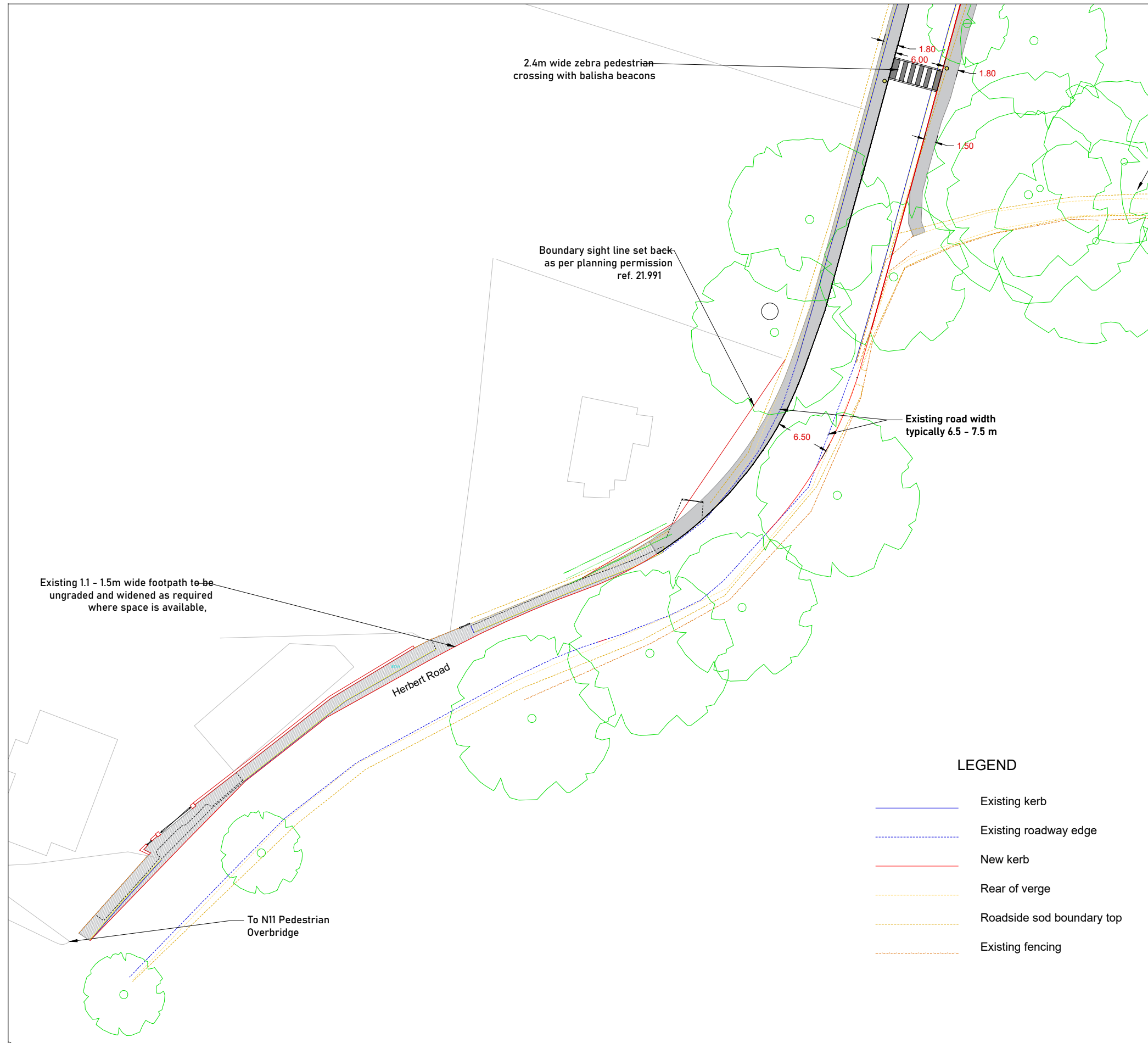

Existing view northwards towards hairpin bend



Existing view westwards of narrow footpath



Designed by
Liam Bourke

Checked by

Wicklow County Council
Bray M.D.

Approved by - date XXX	Filename XXX	Date 25/07/22	Scale 1500
----------------------------------	------------------------	-------------------------	----------------------

HERBERT ROAD KILBRIDE FOOTPATH PART 8

LAYOUT PLAN 1 AND EXISTING IMAGES	Edition 1	Sheet 4
--	---------------------	-------------------